



R.KONČAR KONTAKTORI I RELEI D.O.O.

INSTRUCTIONS FOR USE AND MAINTENANCE
УПАТСТВО ЗА УПОТРЕБА И ОДРЖУВАЊЕ
UPUSTVO ZA UPOTREBU I ODRŽAVANJE

CNNB 9, CNNB 12, CNNB 18, CNNB22, CNNB 25, CNNB 30, CNNB 40L

IEC 60947-4-1, EN60947-4-1

Dimension drawing / Димензиски скици / Merne skice

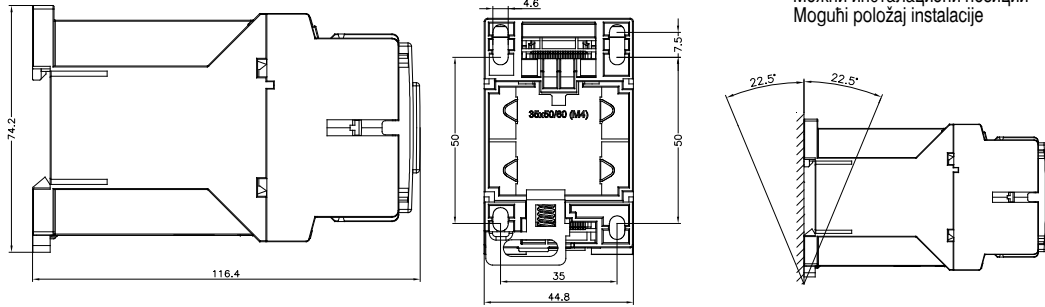

Possible installation positions
Можни инсталациони позиции
Mogući položaj instalacije

Mounting on rail 35mm (DIN 50022) / Монтирање на шина 35mm / Montaža na šinu 35mm

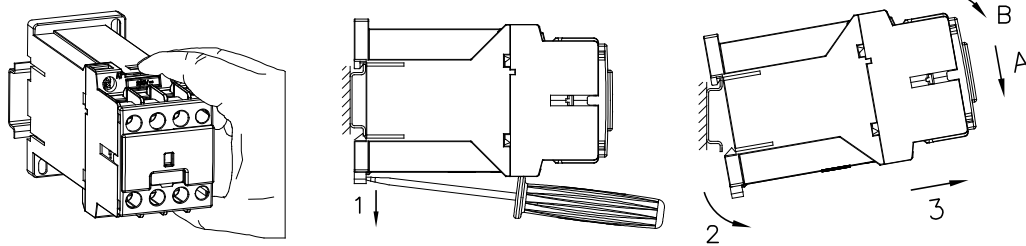

Mounting, of a contactor, steps: A and B.
Unmounting, of a contactor, steps: 1, 2 and 3.

Монтирање на контактор, чекор: А и Б
Демонтирање на контактор, чекор 1, 2 и 3

Montaža kontaktora, korak: A i B
Demontaža kontaktora, korak: 1, 2 i 3

Conductor cross section
Пресек на проводник
Presek provodnika

CNNB 9
CNNB 12
CNNB 18
CNNB 22

CNNB 25
CNNB 30
CNNB 40L

| | | | | |
|-----------|--|-------|--------|-----------------|
| Solid | | 1.5-6 | 2.5-10 | mm ² |
| | | 1.5-6 | 2.5-10 | |
| | | 1.5-6 | 2.5-10 | |
| Fine Wire | | 1-4 | 1.5-6 | |
| | | 1-4 | 1.5-6 | |
| | | 1-4 | 1.5-6 | |
| | | 1-4 | 1.5-6 | |

Replacement of the coil
Замена на калем
Zamena kalema

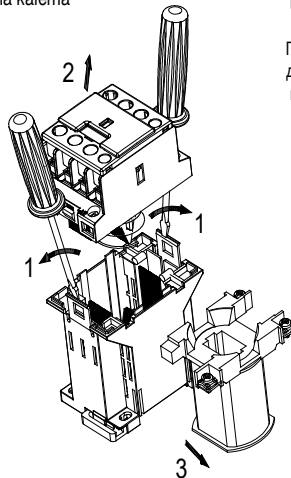

After placing the coil into the lower part put two pressboards like it is shown in the picture (between body of coil and core)
По поставувањето на калемот во долниот дел вметни ги двата прешпани како што е прикажано на сликата (помеѓу телото на калем и јадрото)

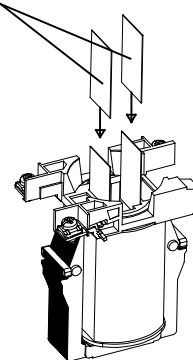

R.KONČAR KONTAKTORI I RELEI D.O.O.

INSTRUCTIONS FOR USE AND MAINTENANCE
УПАТСТВО ЗА УПОТРЕБА И ОДРЖУВАЊЕ
UPUSTVO ZA UPOTREBU I ODRŽAVANJE

CNNB 9, CNNB 12, CNNB 18, CNNB22, CNNB 25, CNNB 30, CNNB 40L

IEC 60947-4-1, EN60947-4-1

Dimension drawing / Димензиски скици / Merne skice

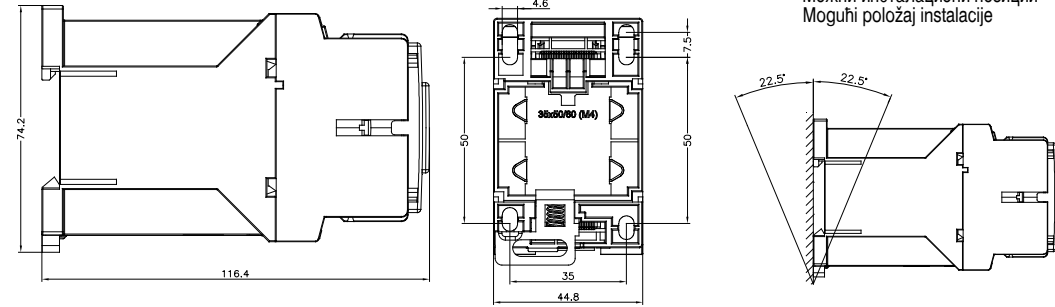

Possible installation positions
Можни инсталациони позиции
Mogući položaj instalacije

Mounting on rail 35mm (DIN 50022) / Монтирање на шина 35mm / Montaža na šinu 35mm

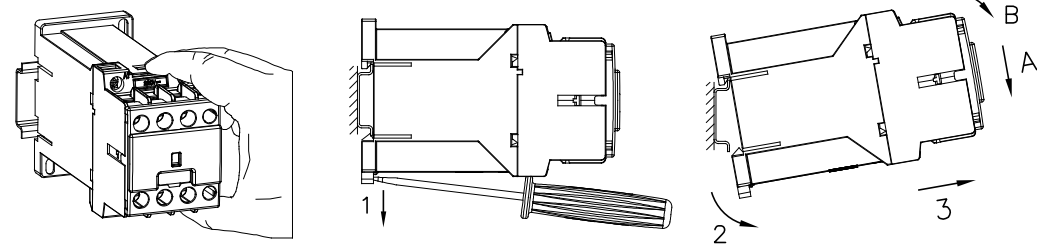

Mounting, of a contactor, steps: A and B.
Unmounting, of a contactor, steps: 1, 2 and 3.

Монтирање на контактор, чекор: А и Б
Демонтирање на контактор, чекор 1, 2 и 3

Montaža kontaktora, korak: A i B
Demontaža kontaktora, korak: 1, 2 i 3

Conductor cross section
Пресек на проводник
Presek provodnika

CNNB 9
CNNB 12
CNNB 18
CNNB 22

CNNB 25
CNNB 30
CNNB 40L

| | | | | |
|-----------|--|-------|--------|-----------------|
| Solid | | 1.5-6 | 2.5-10 | mm ² |
| | | 1.5-6 | 2.5-10 | |
| | | 1.5-6 | 2.5-10 | |
| Fine Wire | | 1-4 | 1.5-6 | |
| | | 1-4 | 1.5-6 | |
| | | 1-4 | 1.5-6 | |
| | | 1-4 | 1.5-6 | |

Replacement of the coil
Замена на калем
Zamena kalema

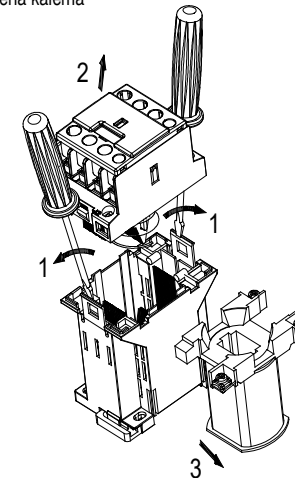

After placing the coil into the lower part put two pressboards like it is shown in the picture (between body of coil and core)
По поставувањето на калемот во долниот дел вметни ги двата прешпани како што е прикажано на сликата (помеѓу телото на калем и јадрото)

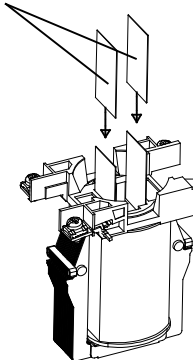

Mounting auxiliary blocks BP2 and BP4 / Монтирање помошни блокови БП2 и БП4 / Montaža pomožnih blokova BP2 i BP4

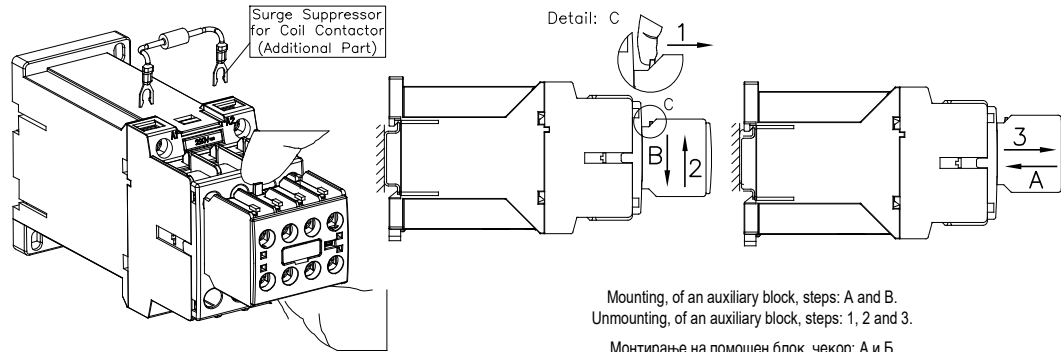

Mounting, of an auxiliary block, steps: A and B.
Unmounting, of an auxiliary block, steps: 1, 2 and 3.

Монтирање на помошен блок, чекор: А и Б
Демонтирање на помошен блок, чекор 1, 2 и 3

Montaža pomožni blok, korak: A i B
Demontaža pomožni blok, korak: 1, 2 i 3

Mounting auxiliary block BP3 (Only one BP3 should be mounted)
Монтирање помошен блок БП3 (Треба да се монтира само едно БП3)
Montaža pomožni blok BP3 (Treba montirati samo jedan BP3)

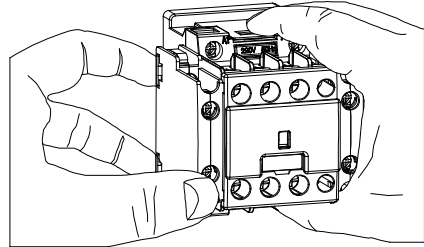

Mounting step A

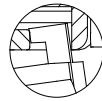

Mounting step B



Mounting step A1

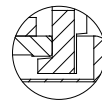

Mounting step B1

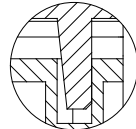

Mounting step C

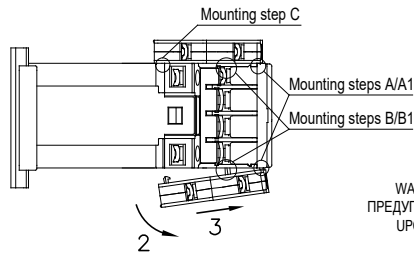
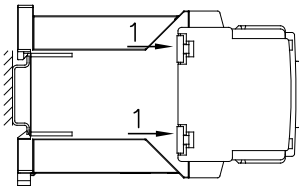

Mounting, of an auxiliary block, steps:
- First put the block in position A/A1 and B/B1, second push the block in position C
Unmounting, of an auxiliary block, steps:
- First put the hand on the block like it is shown on the picture. After with the two fingers push it up the block - position 1, rotate the block - position 2 and position 3 take off the block.

WARNING: Disconnect power from source before installing, modifying or servicing.
ПРЕДУПРЕДУВАЊЕ: Исклучи го напојувањето пред инсталација, менување или сервисирање
UPOZORENJE: Isključiti napajanje izvora pre instalacije, modifikovanje ili servisiranje

Part numb. 503749/A

RK R.KONČAR KONTAKTORI I RELEI D.O.O.

1000 - Skopje, Macedonia, III Makedonska brigada br. 54
Tel./Fax++389 (0)2/ 2461-106; 2465-586; 2463620; 2463-596
E-mail:marketing@radekoncar.com.mk
E-mail:export@radekoncar.com.mk;
http://www.radekoncar.com.mk



Mounting auxiliary blocks BP2 and BP4 / Монтирање помошни блокови БП2 и БП4 / Montaža pomožnih blokova BP2 i BP4

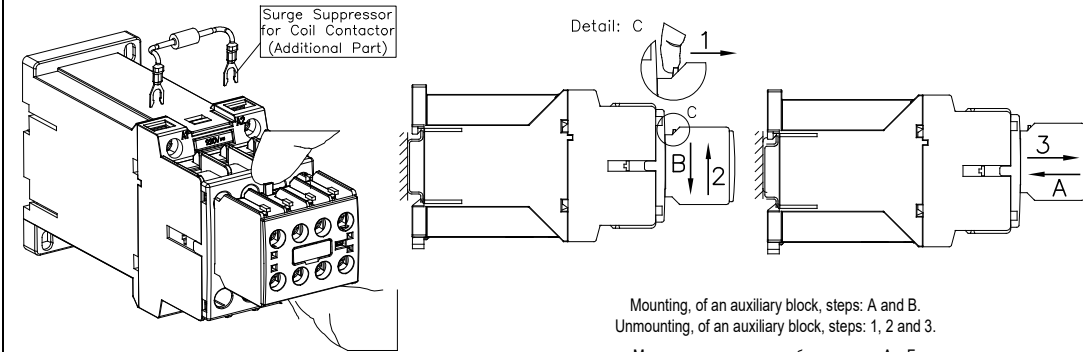

Mounting, of an auxiliary block, steps: A and B.
Unmounting, of an auxiliary block, steps: 1, 2 and 3.

Монтирање на помошен блок, чекор: А и Б
Демонтирање на помошен блок, чекор 1, 2 и 3

Mounting auxiliary block BP3 (Only one BP3 should be mounted)
Монтирање помошен блок БП3 (Треба да се монтира само едно БП3)
Montaža pomožni blok BP3 (Treba montirati samo jedan BP3)

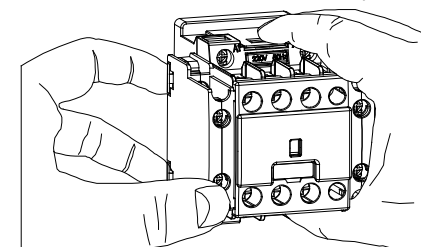

Mounting step A

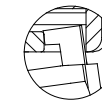

Mounting step B

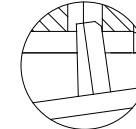

Mounting step A1



Mounting step B1

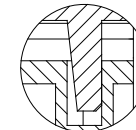

Mounting step C

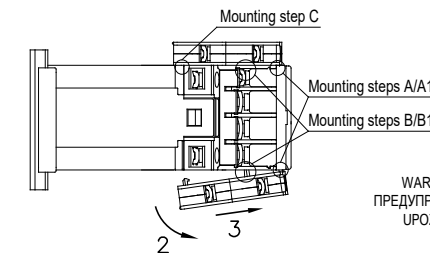
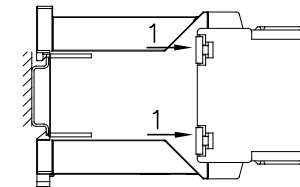

Mounting, of an auxiliary block, steps:
- First put the block in position A/A1 and B/B1, second push the block in position C
Unmounting, of an auxiliary block, steps:
- First put the hand on the block like it is shown on the picture. After with the two fingers push it up the block - position 1, rotate the block - position 2 and position 3 take off the block.

WARNING: Disconnect power from source before installing, modifying or servicing.
ПРЕДУПРЕДУВАЊЕ: Исклучи го напојувањето пред инсталација, менување или сервисирање
UPOZORENJE: Isključiti napajanje izvora pre instalacije, modifikovanje ili servisiranje

Part numb. 503749/A

RK R.KONČAR KONTAKTORI I RELEI D.O.O.

1000 - Skopje, Macedonia, III Makedonska brigada br. 54
Tel./Fax++389 (0)2/ 2461-106; 2465-586; 2463620; 2463-596
E-mail:marketing@radekoncar.com.mk
E-mail:export@radekoncar.com.mk;
http://www.radekoncar.com.mk

